

Examples of Office Projects

Projects Aug 2011 ongoing as bpArchitecture

Cromer Road Depot Offices: Phase 3 development proposals

In Jan 2022 we were appointed to produce drawings and costs for a business case for refurbishment of two office blocks at Stoke on Trent City Council's Cromer Road depot. The budget costs were delivered in June for five mini projects, the two set of offices involved replacement windows, and façade repairs. Replacement suspended ceilings and lighting to all of the offices and some welfare improvements.

MRI Unit St Georges Hospital Tooting

We were appointed in February 2021 to commence design of a new MRI Unit for St Georges NHS Trust, which involved staff offices and rest facilities at First floor to service the MRI unit. Works are at PC Oct 2022

Pinewood Office Block –

In Jan 2021 we were commissioned to produce Scheme Design proposals for a new 3 Storey Office block at Pinewood Studios. Drawings were produced to early stage 4 to allow a contractor to price the tender. We were the preferred design. However, because of the effects of the Pandemic and a review of how the studios would be used to deliver services the project was put on hold.

NMGH – Office Block completed Aug 2021

We were appointed to produce Stage 3D & 4-7 Design of a four storey Office block on North Manchester General Hospital NHS Trust campus to support a major redevelopment of the older buildings on the site.

The £6m project was won on a D&B basis for which we are one of the contractors regional Architects, tender drawings were at late stage 2 design with a live planning application.

We completed the design, supplied drawings to complete the planning application including final external appearance, and did a full regulation check and produced Stage 4 drawings, including liaison with all other consultants as lead consultant, including provision of site support and attendance at Client Meetings remotely.

Works included design of office space over four floor including space planning and interior finishes proposals, staff rest, break out areas and tea station on all floors, and toilet accommodation on all floors, including External works proposals. We were appointed and commenced design in Oct 2020 and works were completed on site August 2021

bpA Office Fit Out – completed Nov 2015

In 2015 we moved office and had the pleasure of designing and managing the fit out of our own office as a full refurbishment.

Marcus House Reception – completed 2012

We were asked to redesign the entrance to an existing building at Park Hall Business Village, which included a new Entrance, Reception, feature Staircase, to improve the letting capability of the building.

Aalco – Biddulph

We were asked to provide proposals for a new 2 storey office to serve the accounts and sales team for national metal distributor.

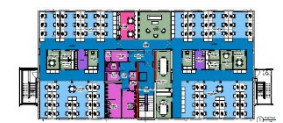

Michael Flanagan Centre: St Georges Hospital Stafford completed Oct 2011
This former Mental Health Isolation Ward was converted to Offices for staff serving a Low Secure and Acute ward below and adjacent, together with office space serving mental health services in the wider community.

Although the building was not listed, it was of significant historic interest, and the works included extensive negotiation with Conservation officer. Works included replacement of windows to the façade, repairs to the roof, and stripping out all other internal finishes back to plaster walls, and providing partitions, toilets, and modern services, with finishes and decorations.

Projects 2003 to 2011 whilst LJT working for Curl La Tourelle Architects

March Lane Depot Tottenham - completed Feb 2022

LJT acted as Architect working for the D& B Contracts WBA and Graham Construction on Marsh Lane Depot a £10 new Depot for Harringay Council which included 200m² of offices and welfare facilities, providing space for Highways, Maintenance, Admin and Security staff at the Depot.

Projects 2003 to Jul 2011 whilst BSP working for Hulme Upright

Animal Management: Reaseheath College completed October 2009
This 1.9m new building constructed as part of the phase 3 redevelopment of the campus included provision of new Manager, Lectures and Keepers offices as part of the development, constructed as a D&B Contract.

Job Centre Plus: Roll Out Programme:

We were District Architect for Stockport and Tameside; Cheshire and Warrington; Humberside and part of Leeds. The project involved the complete rebranding of Job Centre's across the Country.

Works involved forming new Front of house Job Centre Plus branded layouts to public access spaces to high security standards; and back of house office and service accommodation. A number of schemes included Planning Applications for alterations to facades, entrances and external works.

Projects 2002 to 2003 whilst BSP working for AustinSmith Lord

Pavilion: Knowsley Business Park: Grade II

As part of the development of a new Business park we were involved in a number of Scheme Design's one of these involved the design of a new Office with new annexe extensions incorporated a Listed pavilion which marked the entrance to the Business Park

Knowsley Business Park: New HQ Office for Knowsley Housing Trust
As part of development of the Business Park we were involved in the scheme design of this £2.5m new office for Knowsley Housing Trust providing accommodation over two floors.

Knowsley Business Park: New Office Plot 7

Construction of a new speculative Office block over two floors and four potential suites on Knowsley Business Park D&B contract.



Projects 1997 to 2002 *whilst BSP working for Gaunt Francis Associates*

Friars Walk Development Reading for Portfolio Ventures,
Detailed Design of £2.1m office building refurbishing an existing building within part of a larger mixed use development, including rebranding the façade to suite central Reading location immediately opposite the Train station.

Crown House Banbury,

Scheme design for a £1.1m Office Development to upgrade tired unusable building to modern standards

Office: Bloomsbury Square SW1 - Grade II

We were appointed by the Chartered Institute of Arbitrators to oversee the refurbishment of their London headquarters. The works involved the complete refurbishment of the offices and boardrooms including lighting and furniture provision, as well as restoration of feature ceilings and paneling and incorporation of new toilets and doors to meet modern office standards but in keeping with the original interiors.

Hodge House St Mary Street Cardiff 1998 to 2002

Works were carried out over a five year period in a phased redevelopment. The building was spot listed Grade II on the day the phase 2 works started on site.

Phase 2 involved £2.5m alterations to part ground and 2nd to 6th floors:-
A new atrium was formed installing a rooflight over the central lightwell, replacing the 3 lifts, introducing a feature central staircase, reception, and access to three office suites at each level. A second lightwell was infilled to provide new toilet accommodation. All office levels were taken back to shell and fully refurbished, inc new windows, services and finishes.

Phase 3 to 8 works involved Landlords fit out of Offices at each floor and Landlords management of incoming tenants works

Two public houses occupy part ground and 1st floor, Slater Menswear occupy part 1st Floor and the remaining floors are now accommodate 118 UK's call center.

The external works as well as replacement windows involved repair and cleaning of the two principle stone facades and works to improve and modernize entrances on two facades and means of escape from the building, to reflect call centre occupancy.

Negotiation's with Planners, Building Control, Conservation, CADW and the Fire Authority, as well as existing and incoming tenants representatives. This also included insurance claims following a power blow out to the adj sub station.

Westgate Street Office Development Cardiff

We achieved Planning approval for this £2.6m office block with underground car parking facing onto the Millennium Stadium Cardiff
We also designed a Residential scheme for the same site to give the Client dual marketing schemes.

Shoppenhangers House/Voyager Place Maidenhead.

Construction of a new £5.5m office building on the foundations of the existing to form modern office space for Grosvenor Developments.
We then undertook a £3m office scheme to fit out the building to become the HQ of Alcatel (formerly Newbridge Networks)

Saville Row London SW1

Design of a new Corporate Office for Raglan Estates



BBC Worldwide Television

During the early 1997 BSP joined the BBC to oversee the design and restructuring of the much of the office space for BBC Worldwide Television at Woodlands White City. A number of refurbishment and internal office alterations for various departments to reconfigure the complex to make better use of the space – consolidate and expand. Operation efficiencies, better lighting, better finishes, better environment

Projects 1998-2001 *whilst LJT working at Sturgis*

PDK Offices Peterborough

Design of a linear curved two storey office block with sub level to deal with change in levels across the site.

Mount Street, London

Total refurbishment of a 2,200 m2 office block to form air conditioned office space – Client Prudential

Projects 1987 to 1998 *whilst BSP working for Hunter+Partners*

Oversby House Guildford, Surrey for Scottish Provident Institution

This £3.9m scheme involved demolition of poor quality existing building and new development to form high quality office accommodation, ground floor retail accommodation and two levels of sub structure parking

Braywick House, Maidenhead, Berks

Refurbishment of the **Grade II*** listed Braywick House and **Grade II** stable block and construction of a new £4.1m office block wrapping around the stable block to form a courtyard office development, is now Pearce's headquarters. The development included restoration of ceilings and paneling, a helical staircase, restoring timbers, and the creation of landscaped gardens and courtyards in keeping with the period of the property.

BBC Woodlands Block A Ground Floor Refurbishment

The ground floor of one of BBC Woodlands offices was taken back to shell and refurbished to provide offices for a department being relocated from elsewhere in their complex. .

3-5 Burlington Gardens, London W1

Commercial Office Refurbishment: for Scottish Widows Life Fund

This £5.2m office refurbishment provided 6 floors of high quality fully air conditioned offices with 2 directors flats at 7th floor, retention of retail developments at ground floor. (3 shops and Ceconi's restaurant traded during the contract.

We also designed images for the Site Hoarding for this development which won a rewarding hoarding competition

14 Cockspur St, London WC1.

This £5.2m Grade II listed building former banking Hall. Major refurbishment to form commercial offices. The banking hall was restored, whilst a new atrium was formed to provide light into the deep plan office space beyond, and the office space surrounding this fully refurbished to provide modern open plan corporate offices with central London specification

12 Portland Square, Bristol

This Grade I listed former bond warehouse in the center of St Paul's was refurbished as an Office development. The facades were retained and the entire interior removed and modern offices created within the original shell. .

